

Liquid Differential Pressure Sensor

Important: Retain these instructions

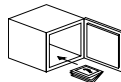

INSTALLATION

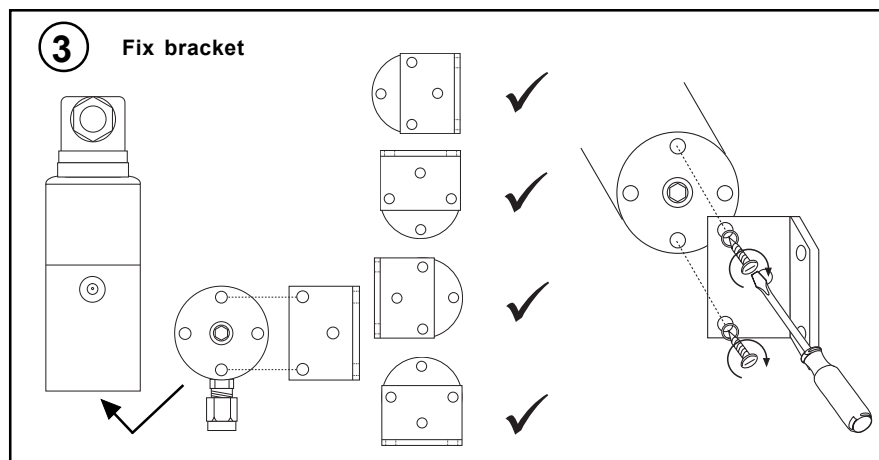
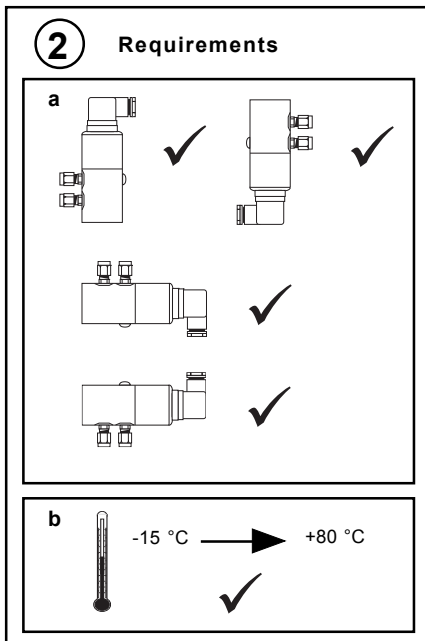
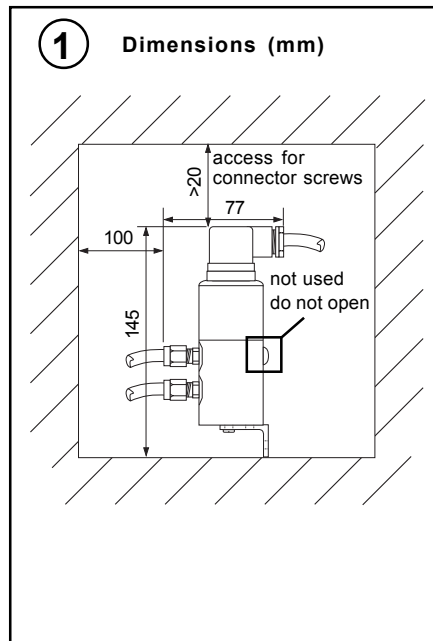

INSTALLATION (continued)

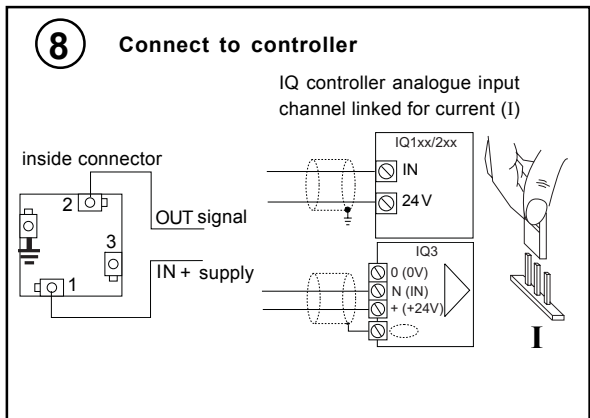
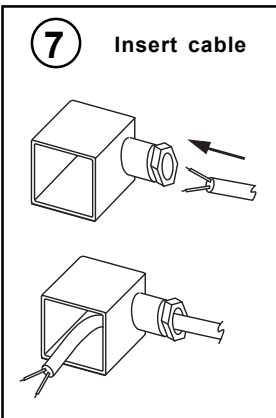
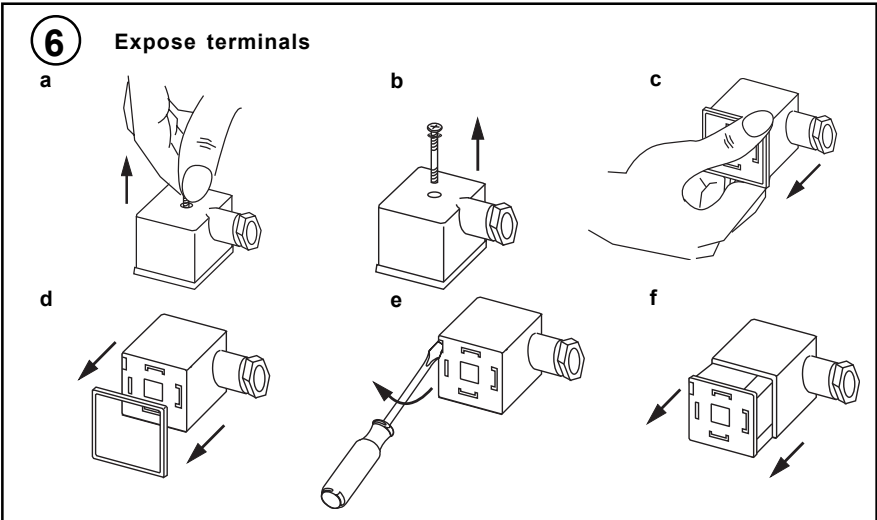
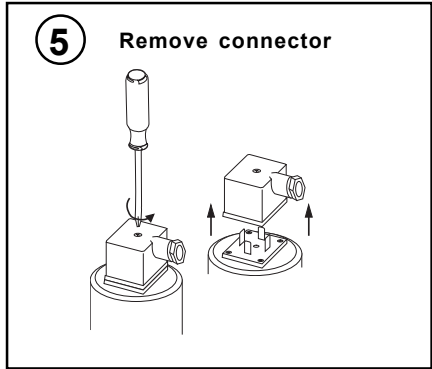
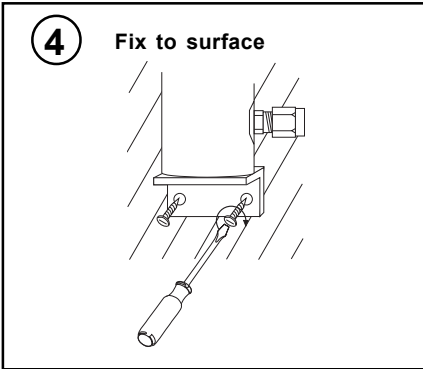

INSTALLATION (continued)

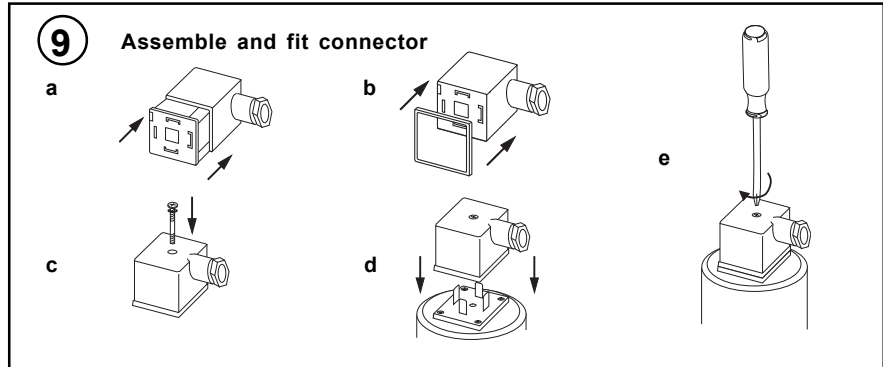

10 Requirements

$P1 > P2$ ✓
 $[P1 < P2]$ ✗

$\Delta p <= \Delta p \text{ max}$

	P max	Δ P max	
	P1 and P2	P1	P2
/0.5	25 bar	3 bar	3 bar
/1	25 bar	5 bar	5 bar
/2.5	25 bar	12 bar	12 bar
/4	25 bar	12 bar	12 bar
/6	25 bar	12 bar	12 bar
/10	25 bar	20 bar	12 bar

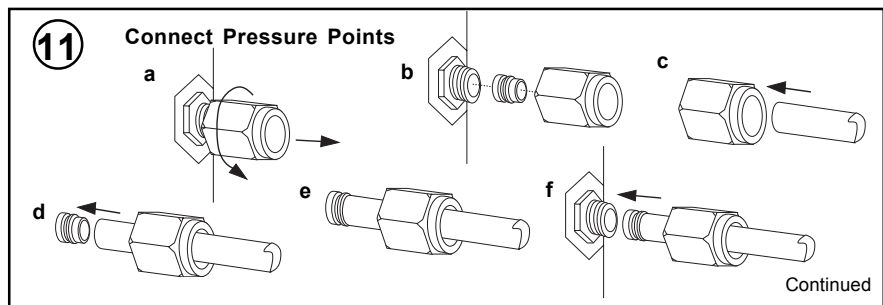

INSTALLATION (continued)

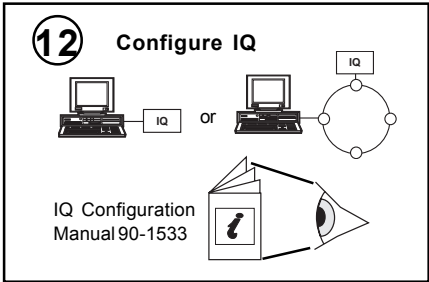
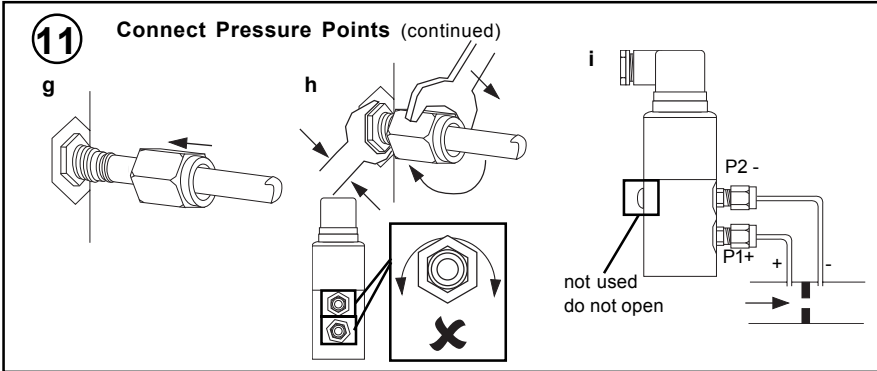

13 Set up sensor type

It is recommended to use SET (software tool) for the setting of sensor type modules.

For all IQ2 series controllers with firmware version 2.1 or greater, or IQ3 series controllers, the following unique sensor references should be used:

DPIL/0.5: **Pressure I 0.5bar**
 DPIL/1: **Pressure I 1bar**
 DPIL/2.5: **Pressure I 2.5bar**
 DPIL/4: **Pressure I 4bar**
 DPIL/6: **Pressure I 6bar**
 DPIL/10: **Pressure I 10bar**

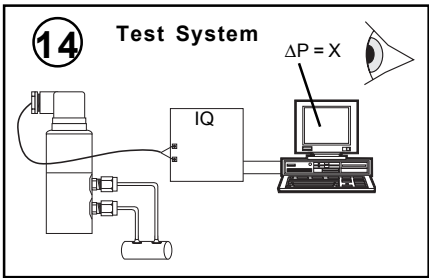

If not using SET, use the following tables for all IQ2 series controllers of firmware version 2.1 or greater or IQ3 controllers; for all other I Q Controllers see Sensor Scaling Reference Card TB100521A

op menu
 tYpe Sensor digI/p Driver Function loGic Loop
 scHedule seQnc Analog digBit Knob sWitch Time
 Zone Oss User addRes intcoN calarM reView Plot
 calEndar
 =? Yx<CR>
 TYPE X
 =?
 S=5 (characterise)
 Y=, E=, U=, L=, P=, I₁ to I₂=, O₁ to O₂=
 X<CR> (current)

DISPOSAL

WEEE Directive :

At the end of their useful life the packaging and product should be disposed of via a suitable recycling centre.
 Do not dispose of with normal household waste.
 Do not burn.

Range	Y	E	U	L	P	I ₁	I ₂	O ₁	O ₂
DPIL/0.5	2	2	0.5	0	2	4	20	0	0.5
DPIL/1	2	2	1	0	2	4	20	0	1
DPIL/2.5	2	2	2.5	0	2	4	20	0	2.5
DPIL/4	2	2	4	0	2	4	20	0	4
DPIL/6	2	2	6	0	2	4	20	0	6
DPIL/10	2	2	10	0	2	4	20	0	10

Manufactured for and on behalf of the Environmental and Combustion Controls Division of Honeywell Technologies Sàrl, Ecublens, Route du Bois 37, Switzerland by its Authorized Representative, Trend Control Systems Limited.

Trend Control Systems Limited reserves the right to revise this publication from time to time and make changes to the content hereof without obligation to notify any person of such revisions or changes.

Trend Control Systems Limited
 P.O. Box 34, Horsham, West Sussex, RH12 2YF, UK. Tel: +44 (0)1403 21888 Fax: +44 (0)1403 241608 www.trend-controls.com