

## PRT Temperature Sensor

**Important: Retain these instructions**

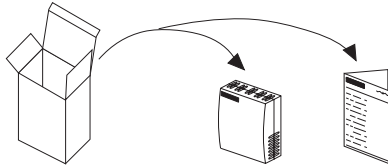

### UNPACKING



T/PS Installation  
Instructions TG200760

### INSTALLATION

**1**

#### Dimensions

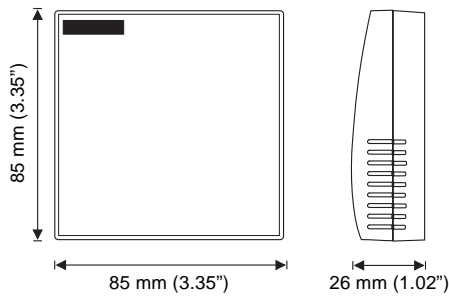

**2**

#### Requirements

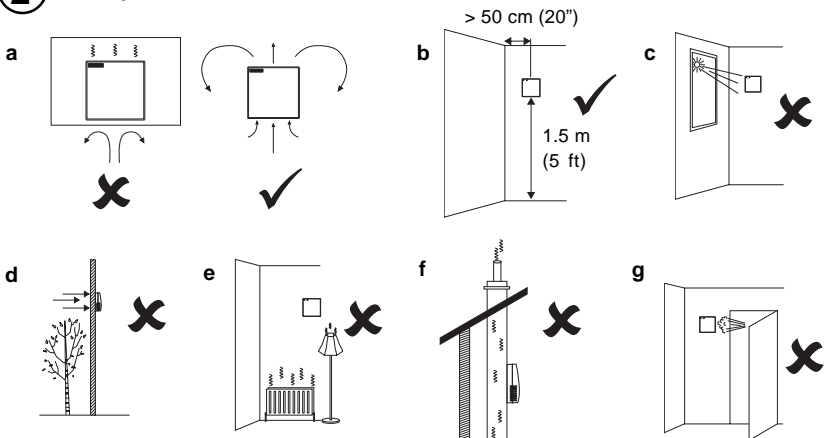



INSTALLATION (continued)

7

Wire to controller

Terminal size 0.5 to 2.5 mm<sup>2</sup> (14 to 20 AWG)

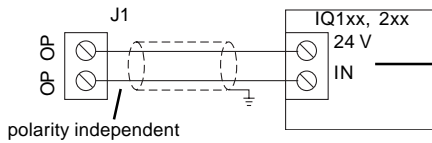
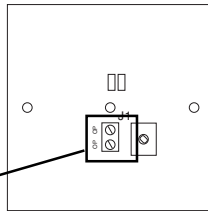

Analogue input channel linked for loop powered current (I)

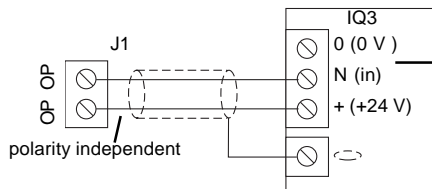
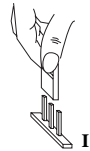

Universal input channel linked for current (I)

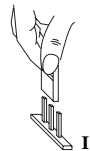

8

Assemble unit

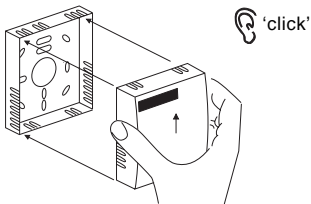

**INSTALLATION** (continued)

**9 Set up IQ Sensor type**

It is recommended to use SET (software tool) for the setting of the sensor type module. For all IQ2 series controllers with firmware version 2.1 or greater, or IQ3 series controllers, select the appropriate SET Unique Reference from the following:

- PRT I -10+40 (°C)**
- PRT I +14+104 F (°F)**

Alternatively enter scaling manually as defined in table below with mode set to 5 (characterise).

For all other IQ controllers see Sensor Scaling Reference Card TB100521A.

Units		°C	°F
<b>Y</b>	Input type	2 (current)	
<b>E</b>	Exponent	3	
<b>U</b>	Upper	40	104
<b>L</b>	Lower	-10	14
<b>P</b>	Points	2	
<b>x</b>	<b>Ix</b>	<b>Ox (°C)</b>	<b>Ox (°F)</b>
<b>1</b>	4	-10	14
<b>2</b>	20	40	104

**10 Test system**

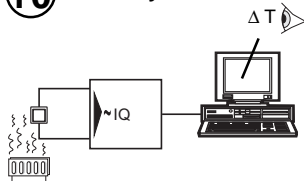

**DISPOSAL**



**WEEE Directive :**

At the end of their useful life the packaging and product should be disposed of by a suitable recycling centre.

- Do not dispose of with normal household waste.
- Do not burn.

Manufactured for and on behalf of the Environmental and Combustion Controls Division of Honeywell Technologies Sàrl, Ecublens, Route du Bois 37, Switzerland by its Authorized Representative, Trend Control Systems Limited.

Trend Control Systems Limited reserves the right to revise this publication from time to time and make changes to the content hereof without obligation to notify any person of such revisions or changes.

**Trend Control Systems Limited**

P.O. Box 34, Horsham, West Sussex, RH12 2YF, UK. Tel: +44 (0)1403 21888 Fax: +44 (0)1403 241608 www.trend-controls.com

**Trend Control Systems USA**

6670 185th Avenue NE, Redmond, Washington 98052, USA. Tel: (425)897-3900, Fax: (425)869-8445 www.trend-controls.com